

Use the following steps to set up your iPhone or iPad to connect to the LSUE Wireless Internet.

1. On the Home Screen, tap the **Settings** icon.

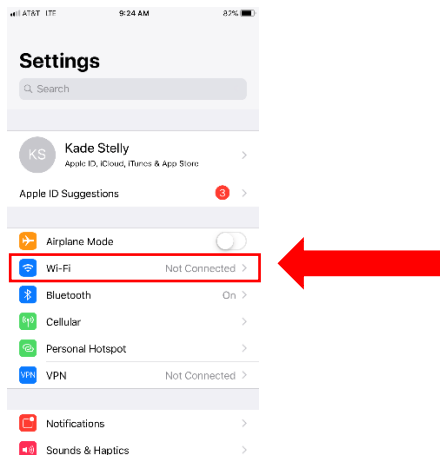

2. Tap **Wifi**.



3. Tap **LSUEStudent** or **LSUEFacultyStaff** under “Choose a network...”.

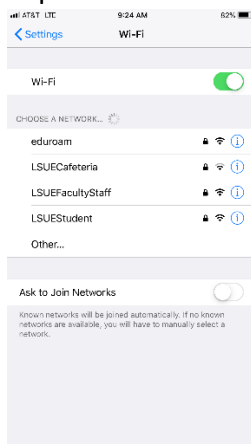

4. Enter your **LSUE Network ID and Password**. Then tap **Join**.

